

****FINAL INSPECTION REQUIRED****
 At the completion of the improvements, please submit a Letter of Substantial Compliance to schedule a Final Inspection.

VEGETATION PERMIT REQUIRED
PRIOR TO ANY SITE WORK
 Protective barricades must be constructed and inspected prior to permit issuance. Please Contact Division of Development Services (239) 533-8585

NORTH BUFFER #1
 30' TYPE 'F' BUFFER

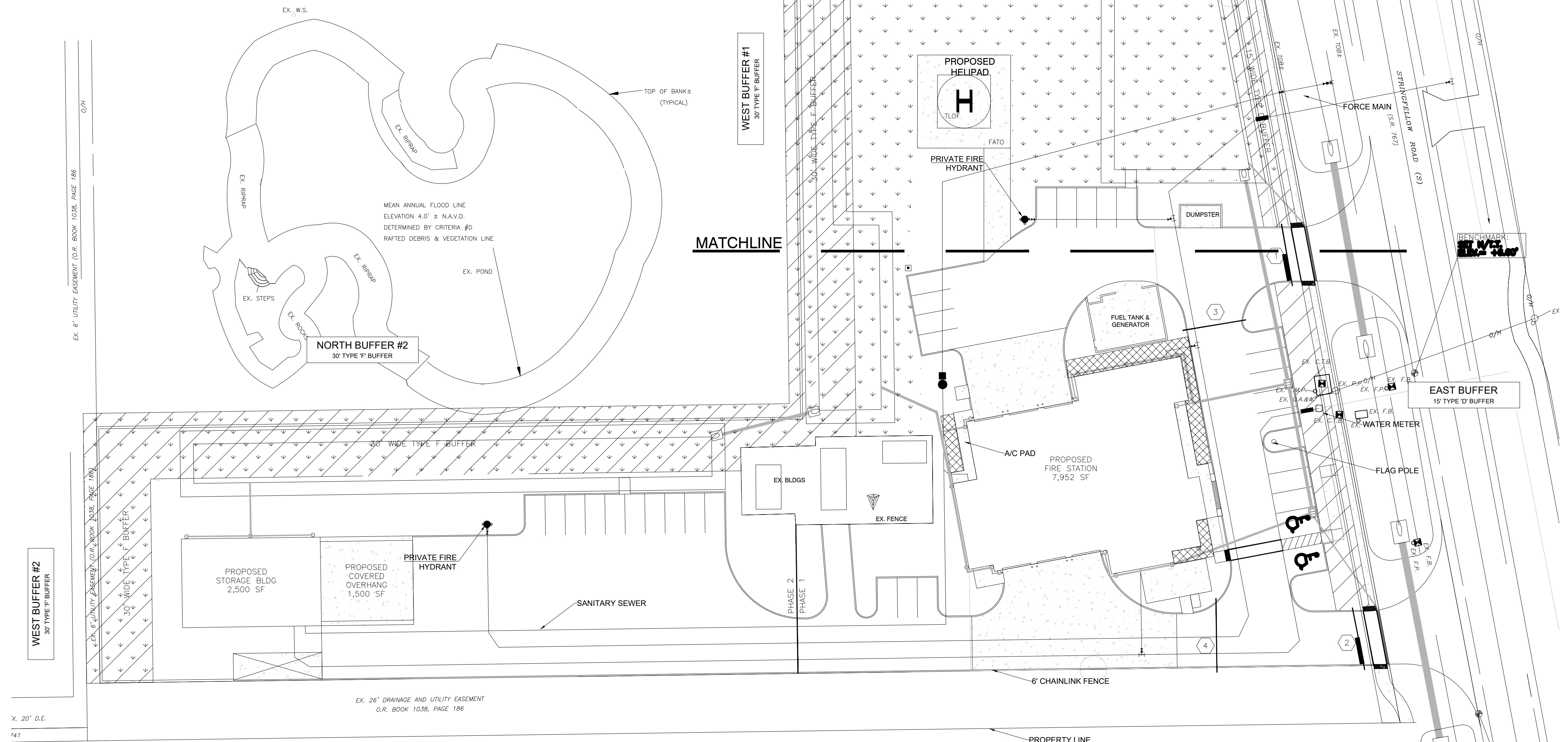

SITE DATA
 STRAP: 23-45-22-00-01002.0020
 ZONING: CFPD Z-22-039, DCI 2022-00029
 SITE ADDRESS: 50 5 STRINGFELLOW ROAD
 ST. JAMES CITY, FL
 PARCEL/DEVELOPMENT AREA: 130,048 S.F. (~3.17 AC.)

GENERAL LANDSCAPE REQUIREMENTS
 COMMERCIAL DEVELOPMENTS REQUIRE ONE TREE PER 3,500 S.F. OF DEVELOPMENT SITE AREA
 $130,048 / 3,500 = 40$ TREE CREDITS REQUIRED AND 40 TOTAL CREDITS TO BE PROVIDED, LABELED AS GENERAL (G).

OPEN SPACE CALCULATIONS
 30% OPEN SPACE
 $130,048 \times 30\% = 41,415$ S.F. REQUIRED AND 43,950 S.F. PROVIDED PER HATCHING SHOWN.

BUILDING PERIMETER PLANTINGS
 10% OF BUILDING AREA TO BE PROVIDED IN BUILDING FOUNDATION PLANTINGS.

$1,352$ SF $\times 10\% = 135$ SF REQUIRED AND 1,050 SF PROVIDED, PER HATCHING SHOWN.

PARKING AND VEHICLE USE AREA
 VEHICLE USE AREA (V.U.A.) MIN. 10% OF PAVED SURFACE AREA REQUIRED TO BE LANDSCAPED.
 $35,170$ S.F. OF VEHICLE USE AREA PROPOSED.
 $35,170$ S.F. $\times 10\% = 3,518$ S.F. LANDSCAPED AREA REQUIRED AND 3,810 S.F. PROVIDED, PER HATCHING SHOWN.
 ONE TREE / 250 S.F. OF LANDSCAPED AREA REQUIRED:
 $3,518$ S.F. / 250 S.F. OF LANDSCAPED AREA YIELDS 14 TREES REQUIRED AND 14 PROVIDED, LABELED AS PARKING (P).

ENVIRONMENTAL CONDITIONS PER Z-22-039:

THE FIRST DEVELOPMENT ORDER APPLICATION MUST INCLUDE THE FOLLOWING:

- GOPHER TORTOISE SURVEY TO CONFIRM WHETHER BURROWS ARE WITHIN 25 FEET OF DEVELOPMENT. (BY OTHERS)
- LANDSCAPE PLANS MUST REFLECT A 30-FOOT-WIDE TYPE-F BUFFER ALONG THE NORTHWEST PROPERTY LINE, WITH EXCEPTION OF A 11-FOOT ENCROACHMENT PER LD02004-00312. THE REMAINING 19-FOOT BUFFER AREA MUST COMPLY WITH LDC LANDSCAPING REQUIREMENTS.
- LANDSCAPE PLANS MUST REFLECT A 30-FOOT-WIDE BUFFER ALONG THE NORTH PROPERTY LINE. THE BUFFER MUST INCLUDE A DOUBLE HEDGE ROW 48-INCHES HIGH AT INSTALLATION AND MAINTAINED AT 60-INCHES CANOPY TREES MUST BE DEPICTED AT THE CORNERS OF THE NORTH BUFFER AND CLUSTERED AT FOUR-FOOT-ON-CENTER. TREES MUST BE TEN-FEET-IN-HEIGHT, TWO-INCH CALIFER, AND FOUR-FOOT SPREAD.

DEVIATIONS (RELATED TO LANDSCAPE)

- BUFFER DEVIATION (2) SEEKS RELIEF FROM THE LDC §10-416(DX4) REQUIREMENT FOR A TYPE F BUFFER TO BE A MINIMUM OF 30 FEET WIDE TO ALLOW THE EXISTING CELL PHONE TOWER TO ENCR OACH INTO THE 30-FOOT-WIDE TYPE F BUFFER BY APPROXIMATELY 11 FEET, LEAVING 19 FEET FOR THE BUFFER/BUFFER VEGETATION. THIS DEVIATION IS APPROVED, SUBJECT TO CONDITION 3-B.
- BUFFER DEVIATION (3) SEEKS RELIEF FROM THE LDC §10-416(DX4) REQUIREMENT TO PROVIDE A TYPE F BUFFER CONSISTING OF 10 TREES PER 100 LINEAR FEET TO ALLOW THE TYPE F BUFFER TO CONSIST OF 5 TREES PER 100 LINEAR FEET NEAR THE PROPOSED HELIPAD AND FOR THOSE TREES TO BE CLUSTERED NEAR THE PROPERTY CORNERS. THIS DEVIATION IS APPROVED, SUBJECT TO CONDITION 3-C.

BUFFER REQUIREMENTS

NORTH BUFFER #1
 30' TYPE 'F' BUFFER REQUIRED 5 TREES PER 100' (PER DEVIATION) AND DOUBLE HEDGE ROW OF SHRUBS AT 48" HT
 200' L.F. $+ 100 \times 5 = 10$ TREES REQUIRED AND 10 TO BE PROVIDED
 200' L.F. $+ 3 \times 2 = 133$ SHRUBS REQUIRED AND 133 TO BE PROVIDED

WEST BUFFER #1
 30' TYPE 'F' BUFFER REQUIRED 5 TREES PER 100' (PER DEVIATION) AND DOUBLE HEDGE ROW OF SHRUBS AT 48" HT
 200' L.F. $+ 100 \times 5 = 11$ TREES REQUIRED AND 11 TO BE PROVIDED
 200' L.F. $+ 3 \times 2 = 139$ SHRUBS REQUIRED AND 139 TO BE PROVIDED

NORTH BUFFER #2
 30' TYPE 'F' BUFFER REQUIRED 10 TREES PER 100' (PER DEVIATION) AND DOUBLE HEDGE ROW OF SHRUBS AT 48" HT
 310' L.F. $+ 100 \times 10 = 31$ TREES REQUIRED AND 31 TO BE PROVIDED
 310' L.F. $+ 3 \times 2 = 207$ SHRUBS REQUIRED AND 207 TO BE PROVIDED

WEST BUFFER #2
 30' TYPE 'F' BUFFER REQUIRED 10 TREES PER 100' (PER DEVIATION) AND DOUBLE HEDGE ROW OF SHRUBS AT 48" HT
 120' L.F. $+ 100 \times 10 = 12$ TREES REQUIRED AND 12 TO BE PROVIDED
 120' L.F. $+ 3 \times 2 = 80$ SHRUBS REQUIRED AND 80 TO BE PROVIDED

EAST BUFFER
 15' TYPE 'D' BUFFER REQUIRED 5 TREES PER 100' AND DOUBLE HEDGE ROW OF SHRUBS
 325' L.F. $+ 100 \times 5 = 16$ TREES REQUIRED AND 16 TO BE PROVIDED
 325' L.F. $+ 3 \times 2 = 217$ SHRUBS REQUIRED AND 217 TO BE PROVIDED

SITE LANDSCAPE CALCULATIONS

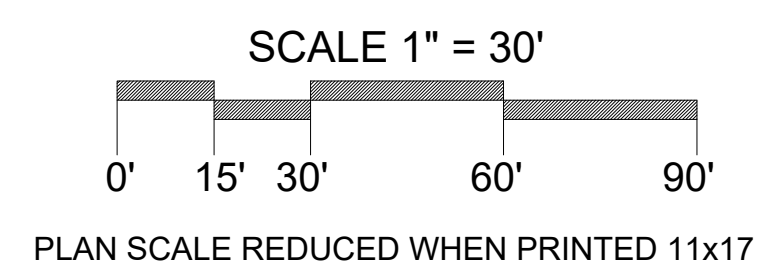

NOTE: ALL LANDSCAPE BUFFERS TO BE INSTALLED IN PHASE I.

GENERAL LANDSCAPE NOTES

- THE QUALITY OF ALL PLANT MATERIAL WILL MEET THE STANDARDS FOR FLORIDA GRADE NO. 1 (or better), AS GOVERNED IN "FLORIDA GRADES AND STANDARDS FOR NURSERY PLANTS, 2022", AS AMENDED.
- ALL PLANTED PALMS WILL HAVE A 3" DEEP SAUCER CONSTRUCTED FROM THE TRUNK OF THE TREE OR PALM. MINIMUM OF 4" DIAMETER.
- ALL PLANTING BEDS SHALL BE COVERED WITH A 3" MINIMUM DEPTH OF MULCH AND SHALL BE WEED FREE. MULCH SHALL BE GRADE B OR BETTER. CONTRACTOR SHALL REMOVE ANY VEGETATIVE GROWTH AND APPLY A PRE-EMERGENT WEED KILLER, PER MANUFACTURER'S SPECIFICATIONS, PRIOR TO MULCHING.
- NO CODE REQUIRED PLANTINGS SHALL BE INSTALLED IN DEDICATED UTILITY EASEMENTS. ALL TREE PLANTING SHALL MAINTAIN A MINIMUM TEN FEET (10') SEPARATION FROM LEE COUNTY UTILITIES INFRASTRUCTURE. ABOVE CODE PLANTINGS SHALL BE REPLACED AT THE OPTION AND COST OF DEVELOPER SHOULD FUTURE UTILITY WORK REQUIRE REMOVAL.
- ALL EXOTIC VEGETATION, INCLUDING: EARLEAF ACACIA, WOMAN'S TONGUE, BISHOPWOOD, AUSTRALIAN PINE, CARROTWOOD, ROSEWOOD, AIR POTATO, MURRAY RED GUM, WEEPING FIG, CUBAN LAUREL FIG, JAPANESE CLIMBING FERN, OLD WORD CLIMBING FERN, MELALEUCA, DOWNY ROSE MYRTLE, CHINESE TALLOW, BRAZILLIAN PEPPER, FLORIDA HOLLY, TROPICAL SODA APPLE, JAVA PLUM, ROSE APPLE, CORK TREE AND WEDELIA, ON THE PROPERTY SHALL BE COMPLETELY REMOVED BY HAND REMOVAL METHODS ONLY, AND DISPOSED OF OFF SITE BY THE CONTRACTOR. THE SITE SHALL BE MAINTAINED FREE OF INVASIVE EXOTIC VEGETATION IN PERPETUITY.
- ALL PLANT MATERIALS SHALL BE GRADED AND MEASURED IN ACCORDANCE WITH THE FLORIDA GRADES AND STANDARDS 2015. GRADING OF PLANT MATERIALS SHALL OCCUR WITHIN THIRTY (30) DAYS OF DELIVERY TO THE JOB SITE.
- A MINIMUM OF 100% OF THE CODE BUFFER TREES AND SHRUBS SHALL BE OF A NATIVE SPECIES.
- THE LANDSCAPE CONTRACTOR SHALL BE RESPONSIBLE FOR FAMILIARIZING THEMSELVES WITH THE LOCATIONS OF ALL UTILITIES AND ALL SITE CONDITIONS PRIOR TO THE START OF LANDSCAPE INSTALLATION.
- THE USE FERTILIZER IS NOT REQUIRED AND SHALL ONLY BE APPLIED WHEN NECESSARY TO SUPPLEMENT PLANT HEALTH AND SHALL BE APPLIED IN ACCORDANCE WITH THE MANUFACTURER'S SPECIFICATIONS AND LOCAL ORDINANCES.
- IT SHALL BE THE RESPONSIBILITY OF THE LANDSCAPE CONTRACTOR TO FINE GRADE ALL PLANTING AND SODDING AREAS PRIOR TO PLANT OR SOD INSTALLATION. CONTRACTOR SHALL OBTAIN OWNER APPROVAL OF FINAL GRADES.
- CONTRACTOR SHALL BE RESPONSIBLE FOR COMPLETE TAKEOFFS. PLANT LIST IS PROVIDED FOR REFERENCE ONLY.
- CONTRACTOR SHALL BE RESPONSIBLE FOR LANDSCAPE MAINTENANCE UNTIL FINAL ACCEPTANCE AND IN COMPLIANCE WITH THE PLANS AND SPECIFICATIONS.
- CONTRACTOR SHALL REMOVE ALL NURSERY TAGS, STAKING TAPE AND SUPPORTS FROM ALL PLANTINGS PRIOR TO FINAL ACCEPTANCE.

- ALL DISTURBED AREAS OF THE DEVELOPMENT SITE NOT PLANTED SHALL BE SODDED IN ACCORDANCE WITH PLANS. REFER TO ENGINEERING PLANS FOR ADDITIONAL SPECIFICATIONS.
- THE REQUIRED PLANTINGS SHALL BE IRRIGATED IN ACCORDANCE WITH LEE COUNTY LDC REQUIREMENTS. REFER TO CONSTRUCTION DOCUMENTS FOR COMPLETE IRRIGATION PLANS.
- THE PARKING LOTS SHALL BE SLEEVED FOR IRRIGATION BY THE LANDSCAPE CONTRACTOR. COORDINATE WITH CIVIL ENGINEERING PLANS.
- ALL BASE ROCK SHALL BE REMOVED FROM LANDSCAPE PARKING ISLANDS.
- PRIOR TO CERTIFICATE OF COMPLIANCE NO TREES SHALL BE PLANTED WHERE THEY DO NOT INTERFERE WITH BUILDINGS, UTILITIES, SITE DRAINAGE, VIEWS, SIGNS, OR WHERE THEY WILL REQUIRE FREQUENT PRUNING TO AVOID POWER LINES AT MATURE HEIGHTS IN PERPETUITY UNLESS A WRITTEN STATEMENT IS PROVIDED PER LDC SEC. 10-421.A.5.
- THE CONTRACTOR SHALL PROVIDE (PRESSURE COMPENSATING SCREENS) AS NECESSARY TO REDUCE OR ELIMINATE OVERSPRAY INTO STREETS, WALKS OR OTHER AREAS AS DICTATED BY THE OWNER'S AUTHORIZED REPRESENTATIVE.
- PLANS ARE PREPARED FOR DEVELOPMENT ORDER APPROVAL ONLY. REFER TO ADDITIONAL LANDSCAPE CONSTRUCTION DOCUMENTS FOR ADDITIONAL REQUIREMENTS.

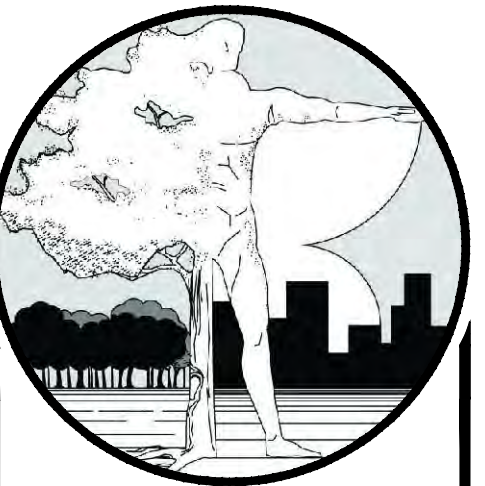

DMJA
 DAVID M. JONES, JR.
 AND ASSOCIATES, INC.
 LANDSCAPE ARCHITECTS
 AND PLANNERS

2221 McGregor Blvd.
 Fort Myers, Florida 33901
 PHONE: (239) 337-5525
 FAX (239) 337-4494

L.A. LICENSE: LC C000063

PROJECT INFORMATION:
PINE ISLAND FIRE DEPARTMENT STATION #2
 St. James, Lee County, Florida

PREPARED FOR:
 TDM Consulting, Inc
 1520 Royal Palm Square Blvd.
 Suite 100
 Fort Myers, FL 33919
 Phone: 239-433-4231
 Fax: 239-433-9632
 Email: dean@tdmconsulting.com

CONSULTANT:

DESIGN PROFESSIONAL:
 Digitally signed by Jarod A. Prentice, R.L.A.
 DN: cn=Jarod A. Prentice, R.L.A., o=Jarod A. Prentice, R.L.A., ou=Jarod A. Prentice, R.L.A., email=jarod@tdmconsulting.com, c=US
 Jarod A. Prentice, R.L.A.
 R.L.A. # LA 6667458
 STATE OF FLORIDA

PROJECT NO.	224071
PROJECT MGR.	Greg Diserio
FILE NAME	ST. JAMES FIRE STATION L.S.
DESIGNER	GJD
CAD TECH	GJD
CHECKED BY	GJD
ISSUED FOR:	PERMITTING

ISSUED DATE:	JAN. 17, 2025
REVISIONS:	
	MARCH 14, 2025 RAI RESPONSE

SHEET TITLE:
 LANDSCAPE CALCULATIONS

SHEET NUMBER:
L - 1

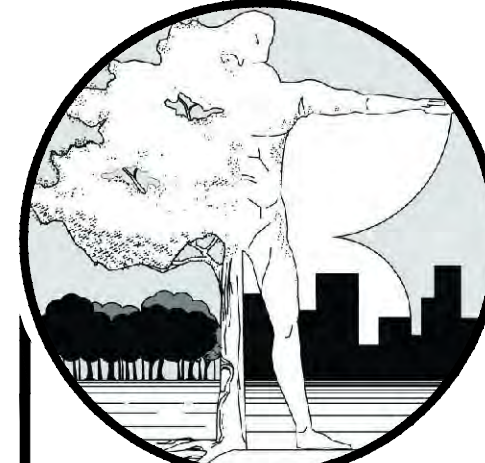

DMJA
 DAVID M. JONES, JR.
 AND ASSOCIATES, INC.
 LANDSCAPE ARCHITECTS
 AND PLANNERS

2221 McGregor Blvd.
 Fort Myers, Florida 33901
 PHONE: (239) 337-5525
 FAX (239) 337-4494

L.A. LICENSE: LC 000063

PROJECT INFORMATION:
**PINE ISLAND
 FIRE
 DEPARTMENT
 STATION #2**
 St. James,
 Lee County,
 Florida

PREPARED FOR:
 TDM Consulting, Inc
 1520 Royal Palm
 Square Blvd.
 Suite 100
 Fort Myers, FL 33919
 Phone:
 239-433-4231
 Fax: 239-433-9632
 Email:
 dean@tdmconsulting.com

CONSULTANT:

DESIGN PROFESSIONAL:
 Digitally signed by Jarod A. Prentice,
 R.L.A.
 Jarod A. Prentice, R.L.A.
 R.L.A. # LA 6667459
 STATE OF FLORIDA

JAROD A. PRENTICE, R.L.A.
 R.L.A. # LA 6667459
 STATE OF FLORIDA

PROJECT NO. 224071
 PROJECT MGR: Greg Diserio
 FILE NAME: ST. JAMES FIRE STATION LS
 DESIGNER: GJD
 CAD TECH: GJD
 CHECKED BY: GJD
 ISSUED FOR:
 PERMITTING

ISSUED DATE: JAN. 17, 2025
 REVISIONS:
 MARCH 14, 2025 RAI RESPONSE

SHEET TITLE:
**LANDSCAPE
 PLAN**

SHEET NUMBER:
L - 2

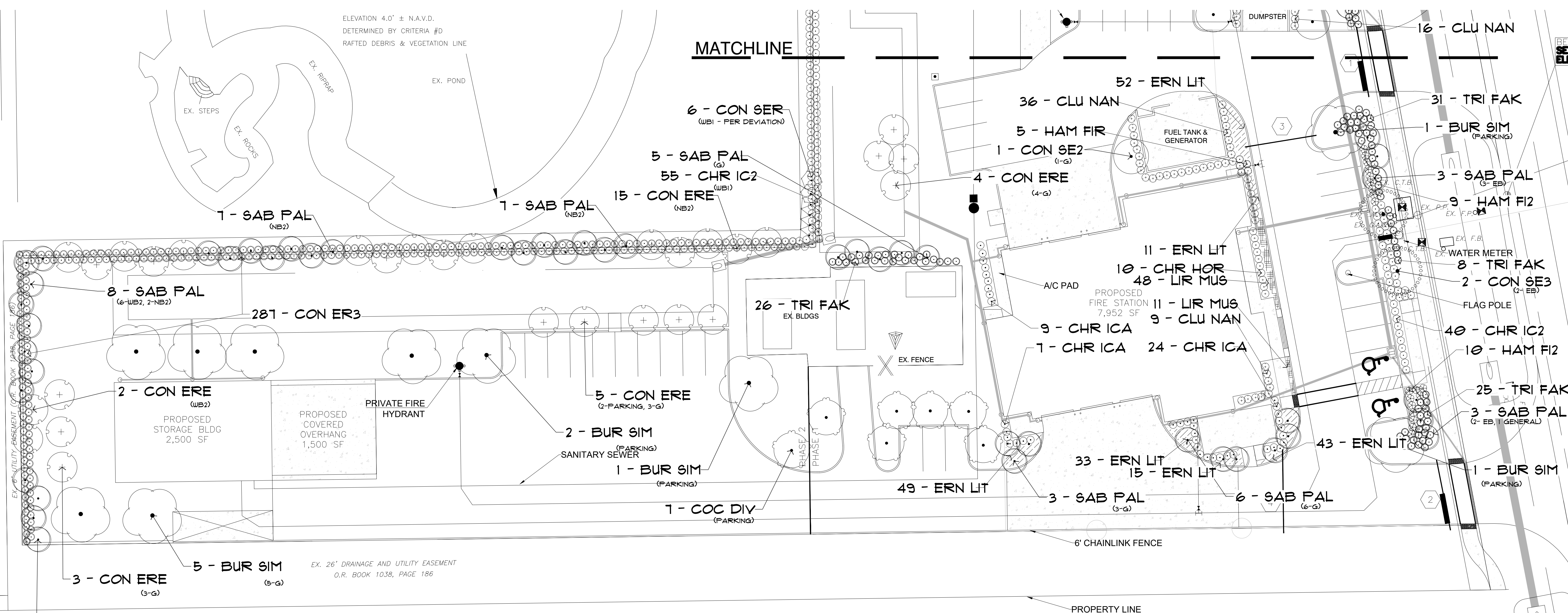

LANDSCAPE PLAN

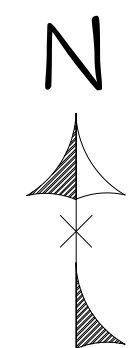
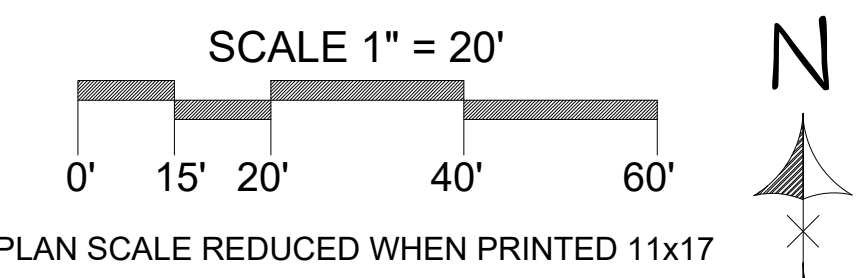

INTERNAL UTILITY EASEMENT - NO TREES OR LARGE SHRUBS SHALL BE PLANTED INSIDE THESE ZONES. ALL TREES IN ISLANDS ARE LOCATED OUTSIDE OF EASEMENT, MIN. 10' FROM BACK OF CURB

M:\2024\Jobs & Proj\2024\Jobs\St. James Fire Station 2 - 224071\Drawings\St. James Fire Station 2 - 224071\DWG\2025-0017-Landscape Plan.dwg, 3/17/2025, 8:15:01 AM, AutoCAD PDF (Web and Mobile).pc3



DMJA
 DAVID M. JONES, JR.
 AND ASSOCIATES, INC.
 LANDSCAPE ARCHITECTS
 AND PLANNERS

2221 McGregor Blvd.
 Fort Myers, Florida 33901
 PHONE: (239) 337-5525
 FAX (239) 337-4494

L.A. LICENSE: LC 000063

PROJECT INFORMATION:
**PINE ISLAND
 FIRE
 DEPARTMENT
 STATION #2**
 St. James,
 Lee County,
 Florida

PREPARED FOR:
 TDM Consulting, Inc
 1520 Royal Palm
 Square Blvd.
 Suite 100
 Fort Myers, FL 33919
 Phone:
 239-433-4231
 Fax:
 239-433-9632
 Email:
 dean@tdmconsulting.com

CONSULTANT:

DESIGN PROFESSIONAL:
 Digitally signed by Jarod A. Prentice, R.L.A.
 DN: cn=Jarod A. Prentice, R.L.A., o=Jarod A. Prentice, R.L.A., ou=Jarod A. Prentice, R.L.A., email=jarod@tdmconsulting.com, c=US
 Date: 2025.08.06 11:58:19 -0400
 Jarod A. Prentice, R.L.A.
 R.L.A. # LA 6667459
 STATE OF FLORIDA

PROJECT NO. 224071
 PROJECT MGR: Greg Diserio
 FILE NAME: ST. JAMES FIRE STATION L.S.
 DESIGNER: GJD
 CAD TECH: GJD
 CHECKED BY: GJD
 ISSUED FOR:
PERMITTING

ISSUED DATE: JAN. 17, 2025
 REVISIONS:
 MARCH 14, 2025 RAI RESPONSE

SHEET TITLE:
**LANDSCAPE PLAN
 & SCHEDULE**

SHEET NUMBER:
L - 3

2025-03-12 10:56

PLANT SCHEDULE					
SYMBOL	CODE	QTY	COMMON / BOTANICAL NAME	SIZE	
TREES					
	CON ERE	29	Buttonwood Conocarpus erectus Native	Min. 2" Cal., 10' Ht., 4' Sprd.	
	SAB PAL	49	Cabbage Palmetto Sabal palmetto Native	10'-16' CT Staggered	
	BUR SIM	10	Gumbo Limbo Bursera simaruba Native	Min. 2" Cal., 10' Ht., 4' Sprd.	
	COC DIV	7	Pigeon Plum Coccoloba diversifolia Native	Min. 2" Cal., 10' Ht., 4' Sprd.	
	CON SE3	3	Silver Buttonwood Conocarpus erectus f. sericeus NATIVE	12' HT., 2.5" CAL., 5' SPR	
	CON SER	21	Silver Buttonwood Conocarpus erectus f. sericeus AT 4' OC PER ZONING	2" Cal., 10' Ht., 4' Sprd.; Standard	
	CON SE2	11	Silver Buttonwood Conocarpus erectus `Sericeus` Native	Min. 2" Cal., 10' Ht., 4' Sprd.	
SHRUBS					
	Con er3	287	Buttonwood Conocarpus erectus NATIVE	10 gallon, 48" min. ht.	
	Chr ic2	326	Coco Plum Chrysobalanus icaco NATIVE	10 gallon, 48" min. ht.	
	Chr ica	123	Cocoplum Chrysobalanus icaco Native	3 gal., 24" ht	
	Clu nan	61	Dwarf Pitch Apple Clusia rosea `Nana` Native	3 gal., 24" ht	
	Tri fak	103	Fakahatchee Grass Tripsacum dactyloides NATIVE	3 gal., 24" ht	
	Ham fi2	27	Firebush Hamelia patens NATIVE	10 gallon, 48" min. ht.	
	Ham fir	5	Firebush Hamelia patens Native	3 gal., 24" ht	
	Chr hor	10	Horizontal Cocoplum Chrysobalanus icaco `Horizontalis` Native	Min. 24" Ht., 3 Gallon	
SYMBOL	CODE	QTY	COMMON / BOTANICAL NAME	SIZE	SPACING
GROUND COVERS					
	Lir mus	59	Evergreen Giant Lilyturf Liriope muscari `Evergreen Giant`	1 Gal., 12" Ht., Full	16" o.c.
	Ern lit	203	Golden Creeper Ernodea littoralis	1 gal.	16" o.c.

SCHEDULE AND MATERIALS NOTES:
 ABOVE CODE PLANTINGS (IF APPLICABLE) TO BE INSTALLED AT THE OPTION OF THE OWNER.
 CONTRACTOR SHALL SOD ALL DISTURBED AREAS WITH BAHIA SOD. VERIFY SOD SPECIES/VARIETY WITH OWNER. PRIOR TO BIDDING
 ALL PLANTINGS TO BE MULCHED WITH 2" DARK BROWN ORGANIC MULCH GRADE B OR BETTER. CYPRESS MULCH PROHIBITED.
 CONTRACTOR RESPONSIBLE FOR VERIFICATION OF ALL QUANTITIES AT TIME OF BIDDING.
 CONTRACTOR RESPONSIBLE FOR ALL SOD AND MULCH QUANTITIES.

INTERNAL UTILITY EASEMENT - NO TREES OR LARGE SHRUBS SHALL BE PLANTED INSIDE THESE ZONES. ALL TREES IN ISLANDS ARE LOCATED OUTSIDE OF EASEMENT, MIN. 10' FROM BACK OF CURB

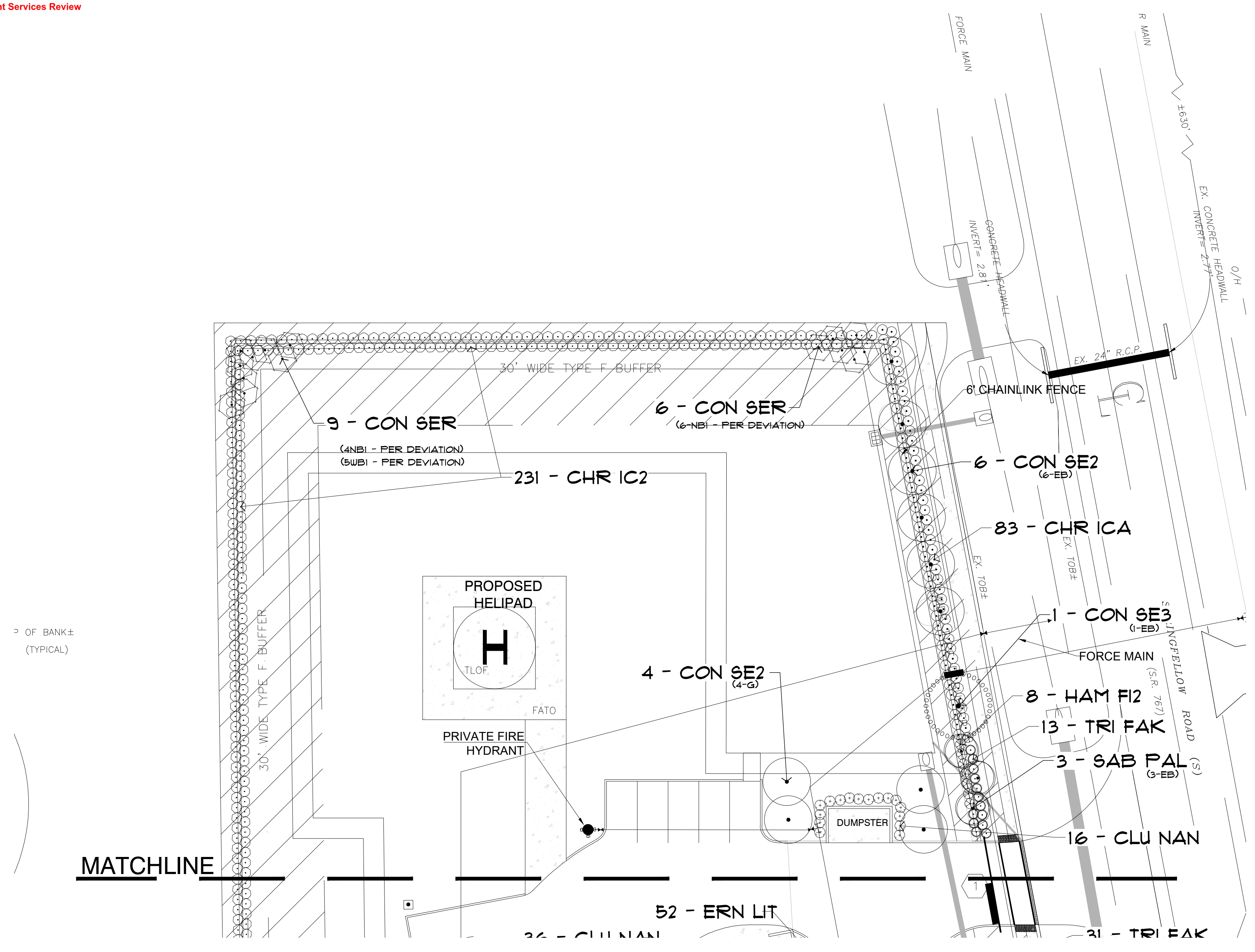

LANDSCAPE PLAN

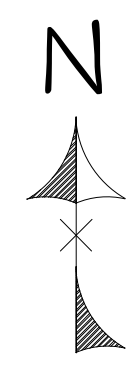
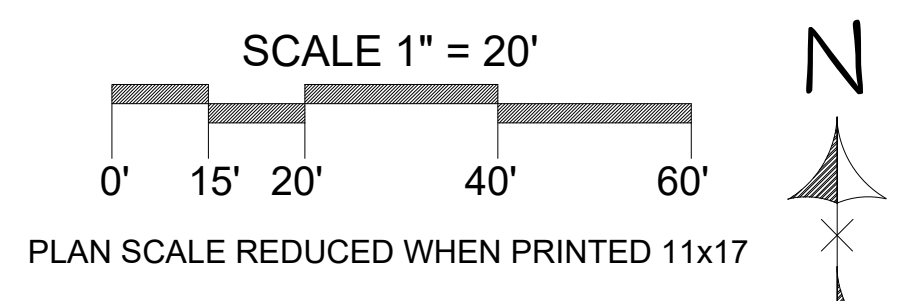

M:\2024\Jobs & Proj\2024\Jobs\St. James City Pine Island Road Fire Station 2 224071\Drawings\st.james.fire.station.2 224071.dwg 3/17/2025 8:14:53 AM AutoCAD PDF (Web and Mobile).pc3

LANDSCAPE DETAILS

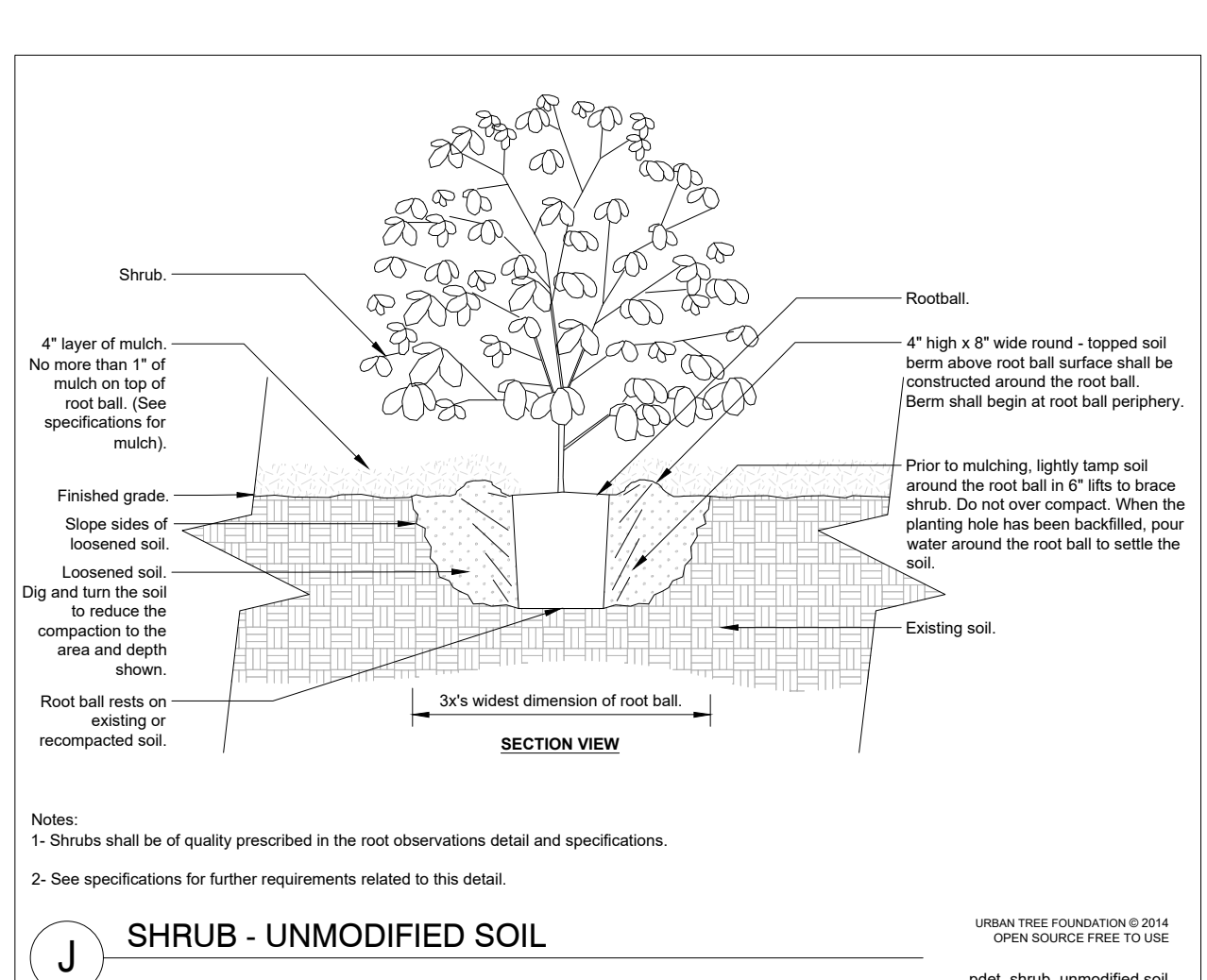
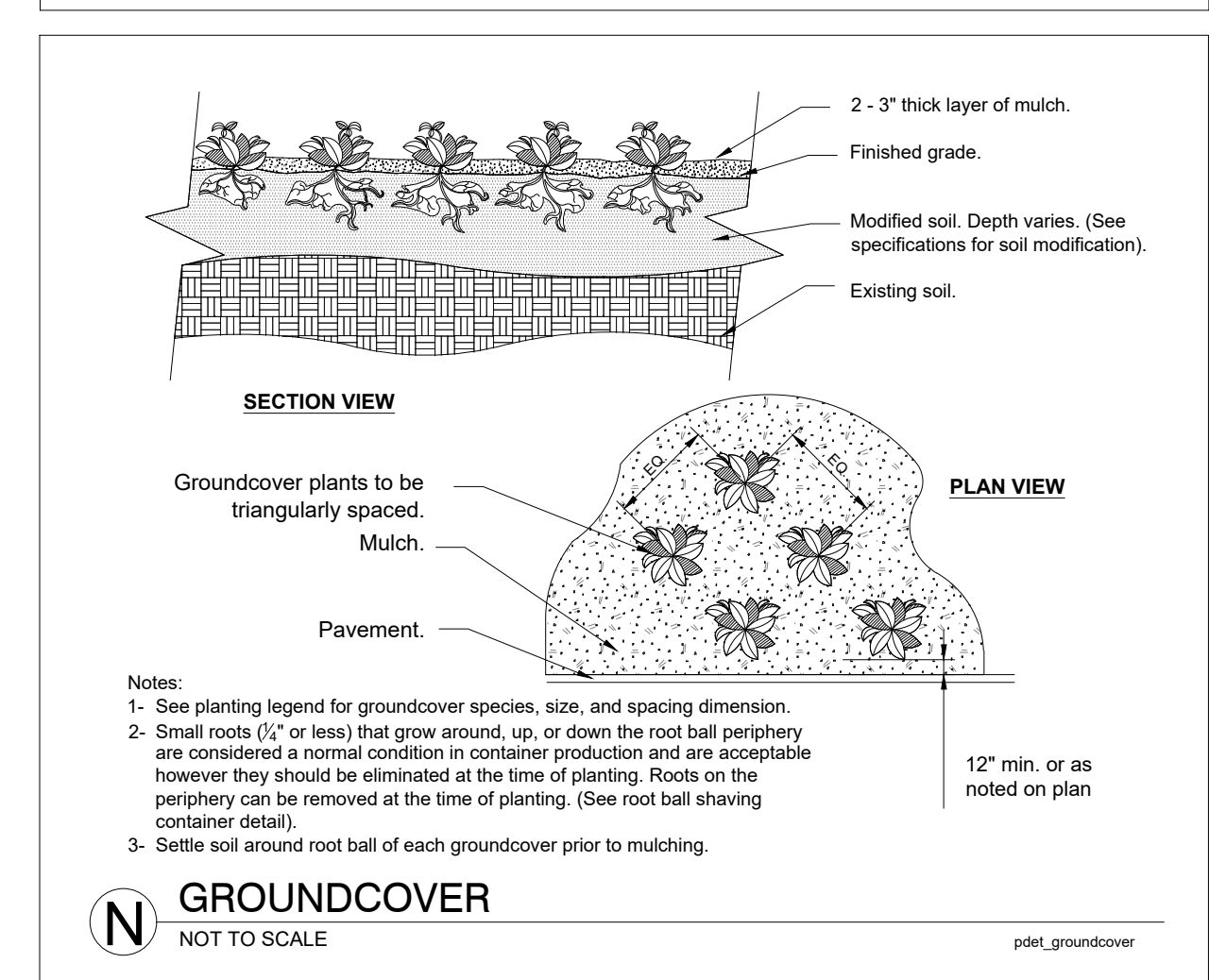
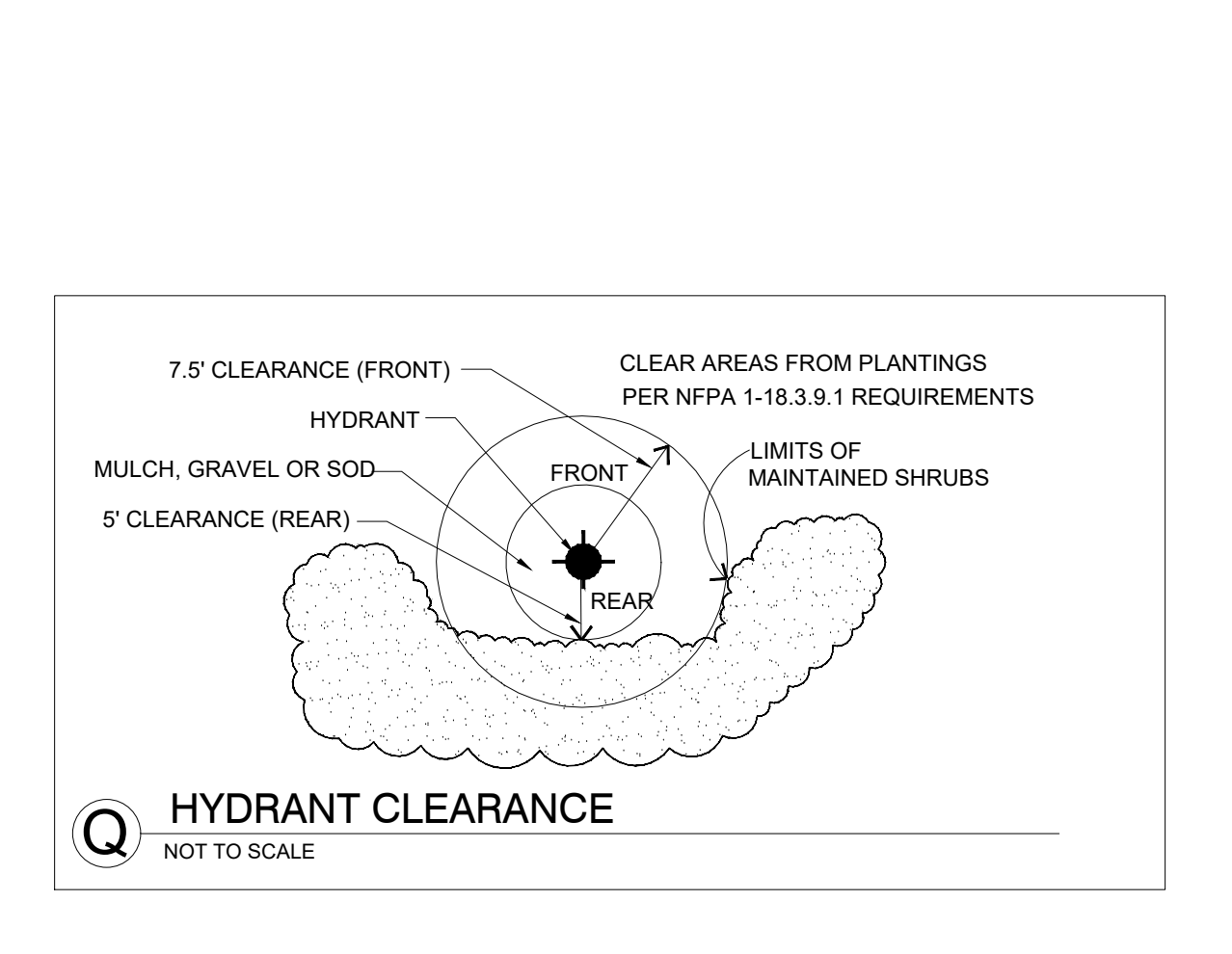
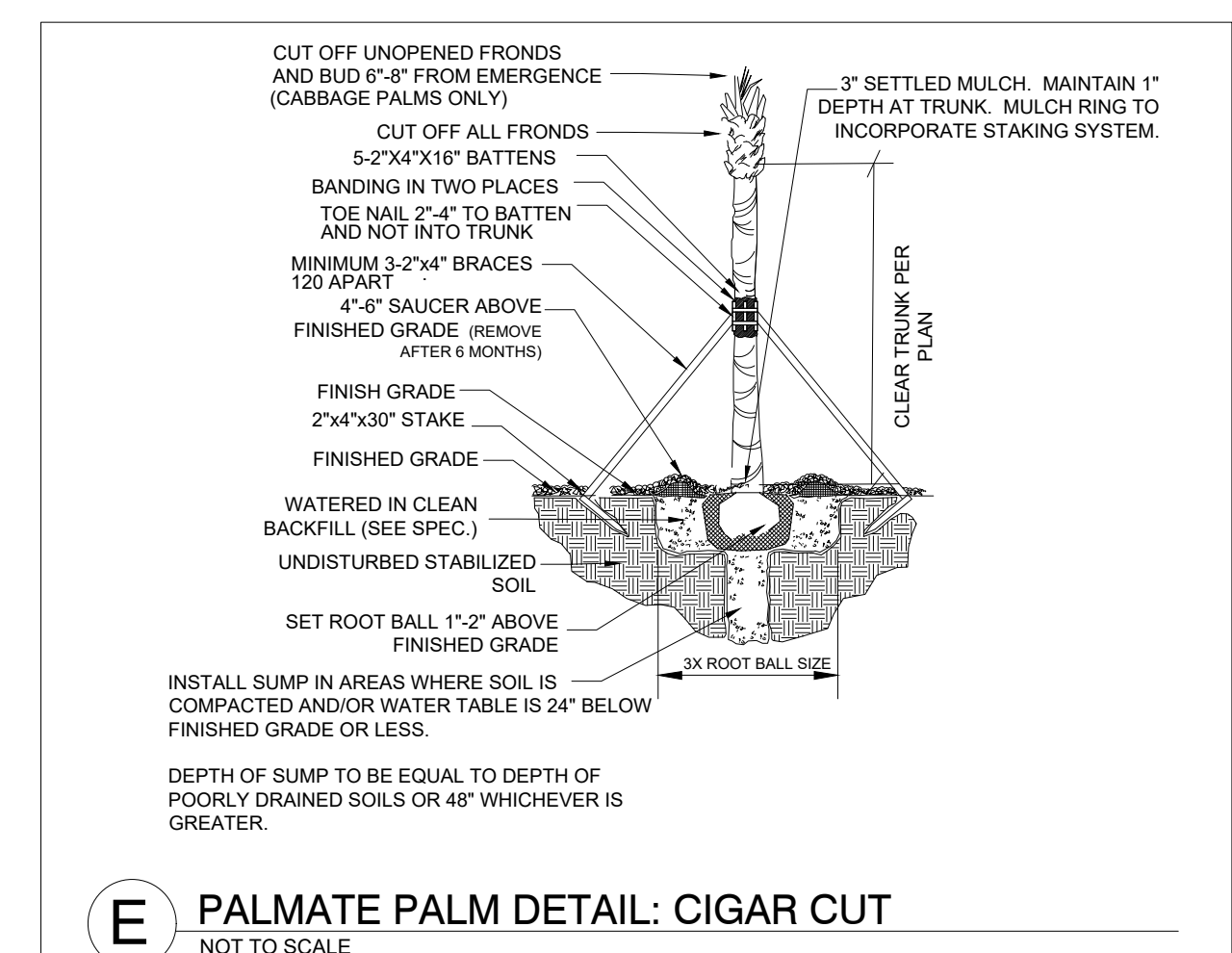
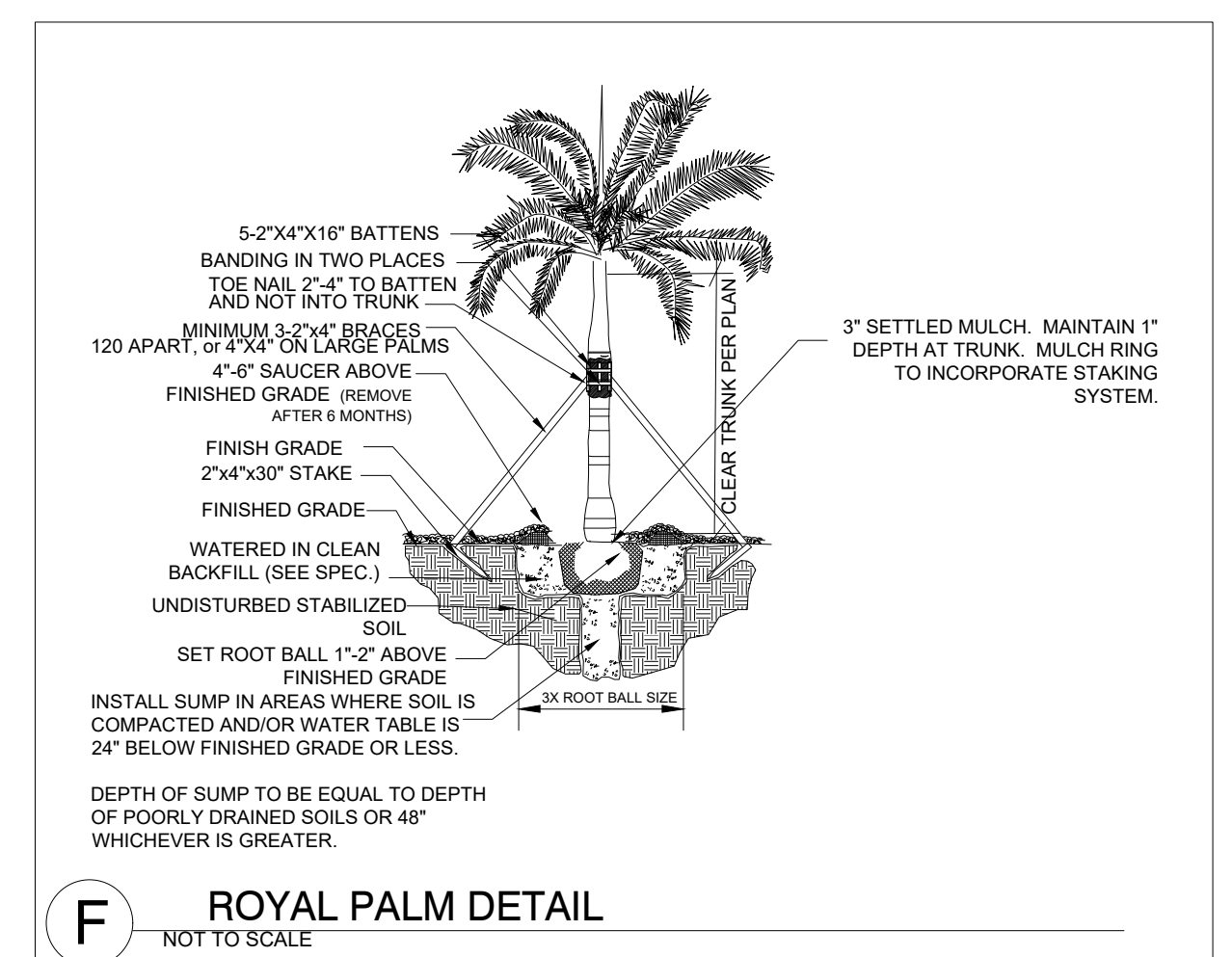
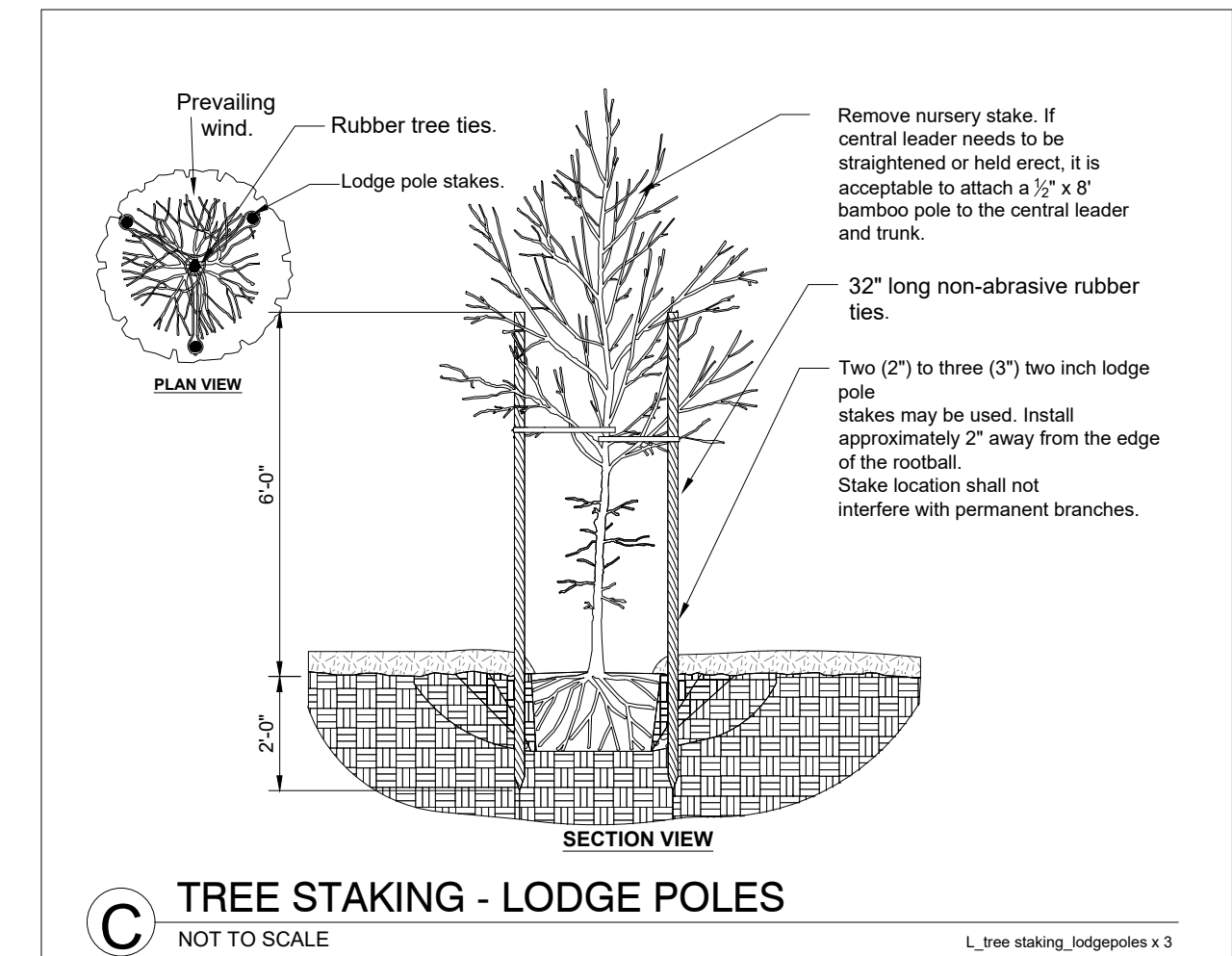
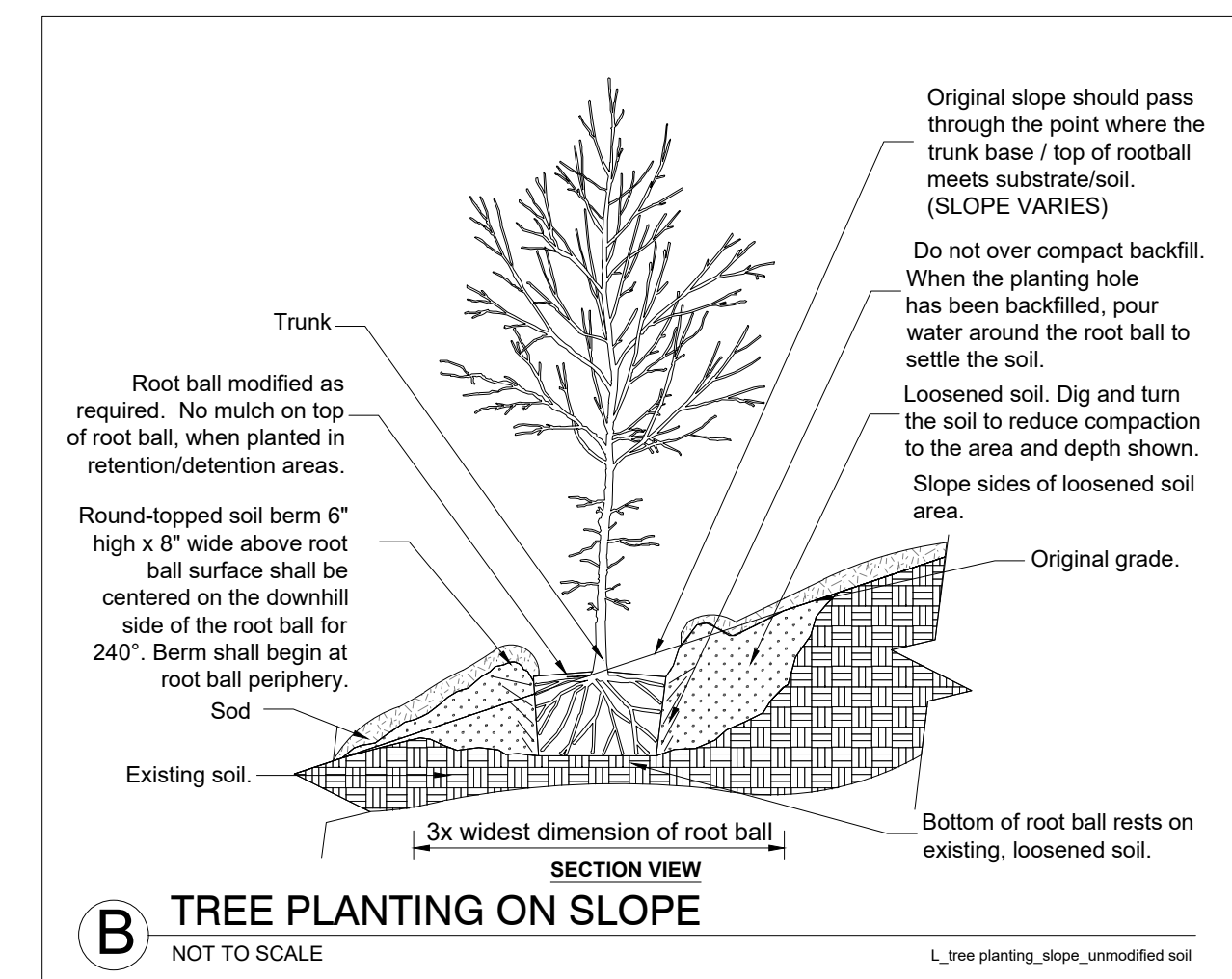
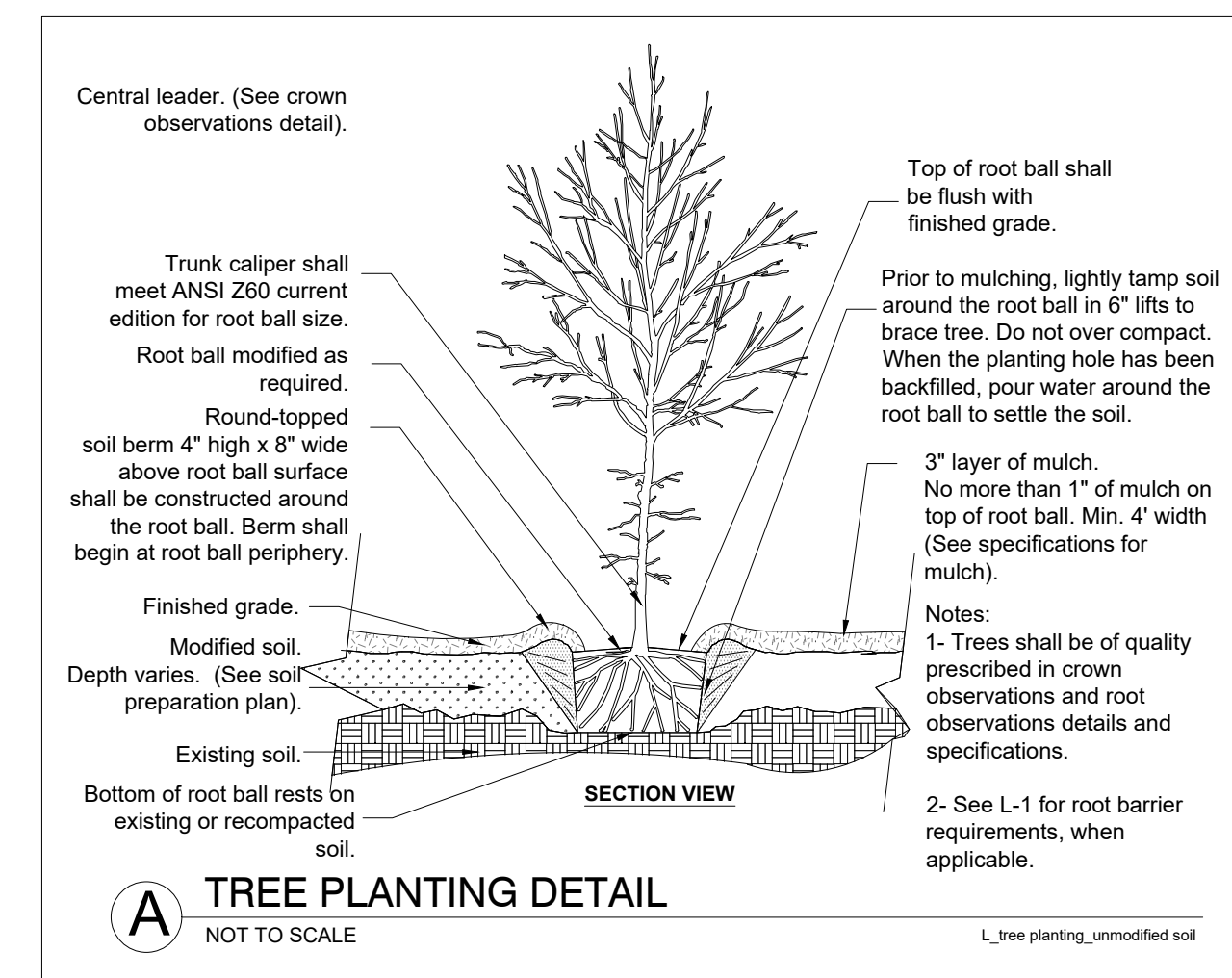

GENERAL IRRIGATION NOTES

- All mainline and lateral line piping and control wires under paving shall be installed in separate sleeves. Main and lateral line sleeves shall be a minimum of twice (2x) the diameter of the pipe to be sleeved. Control wire sleeves shall be sufficient size for the required number of wires under paving.
- Pipe sizes shall conform to those shown on the drawings. No substitutes of smaller pipe sizes shall be permitted but substitutions of larger sizes may be approved. All damaged and rejected pipe shall be removed from the site at the time of said rejection.
- All sprinkler heads shall be set perpendicular to finished grade unless otherwise specified.
- The irrigation contractor shall flush and adjust all sprinkler heads and valves for optimum coverage with minimal overspray onto walks, streets, walls, etc.
- Irrigation heads shall be a minimum of 12" from buildings.
- This sheet is diagrammatic only for code requirements. All piping, valves, etc. shown within paved areas are for design clarification only and shall be installed in planting areas whenever possible. The contractor shall locate all valves in shrub areas where possible.
- It is the responsibility of the irrigation contractor to familiarize himself with all grade differences, location of walls, structures and utilities. The irrigation contractor shall repair or replace all items damaged by his work. He shall coordinate his work with other contractors for the location and installation of pipe sleeves through walls, under roadways and paving, etc.
- Do not willfully install the sprinkler system as shown on the drawings when it is obvious in the field that unknown obstructions, grade differences, water levels or differences in the area dimensions exist that might not have been considered in the engineering. Such obstructions or differences should be brought to the attention of owners representative. In the event this notification is not performed, the irrigation contractor shall assume full responsibility for any revisions necessary.
- All sprinkler equipment not otherwise detailed or specified shall be installed as per manufacturer's recommendations and specifications.
- The contractor shall provide (Pressure Compensating Screens) as necessary to reduce or eliminate over spray into streets, walks or other areas as dictated by the owner's authorized representative.
- All remote control valves, gate valves, quick couplers and control wire splices shall be installed in approved valve boxes with locking covers. All shall be marked indicating controller and station numbers for control valve.
- Contractor to provide the Owner with a complete irrigation design in compliance with Owners program. All required plantings irrigated. Turf to be irrigated at the option of the Owners.
- Irrigation system shall be designed for complete coverage. Verify with owner limits of irrigation prior to bidding.
- The sprinkler system to be based on a minimum operating pressure of 40 PSI. The irrigation contractor shall verify water pressures, flows, elevations, and other requirements prior to construction. Report any differences between the water pressure and flows indicated on drawings and the actual pressure reading at the irrigation point of connection to the owners authorized representative.
- Installer shall conduct final testing and adjustments to achieve design specifications prior to completion of the system and acceptance by the owner or owner's representative.
- The installer shall provide property owners and users with post-construction documentation, including as-constructed drawings, recommended maintenance activities and schedules, operational schedule, design precipitation rates, instructions on adjusting the system to apply less water after the landscape is established, maintenance schedule, water source, water shut-off method, and the manufacturer's operation guide for the irrigation controller. To the extent feasible, similar information should be made available for subsequent property transfers.
- Any changes and/or modifications to the water source shall require appropriate adjustments to the system design.
- The contractor shall be responsible for providing all code required backflow preventers in addition to all permits as required by the governing agencies including water use permits.
- Irrigation system shall be through an irrigation well to be permitted by others.

IRRIGATION DETAILS

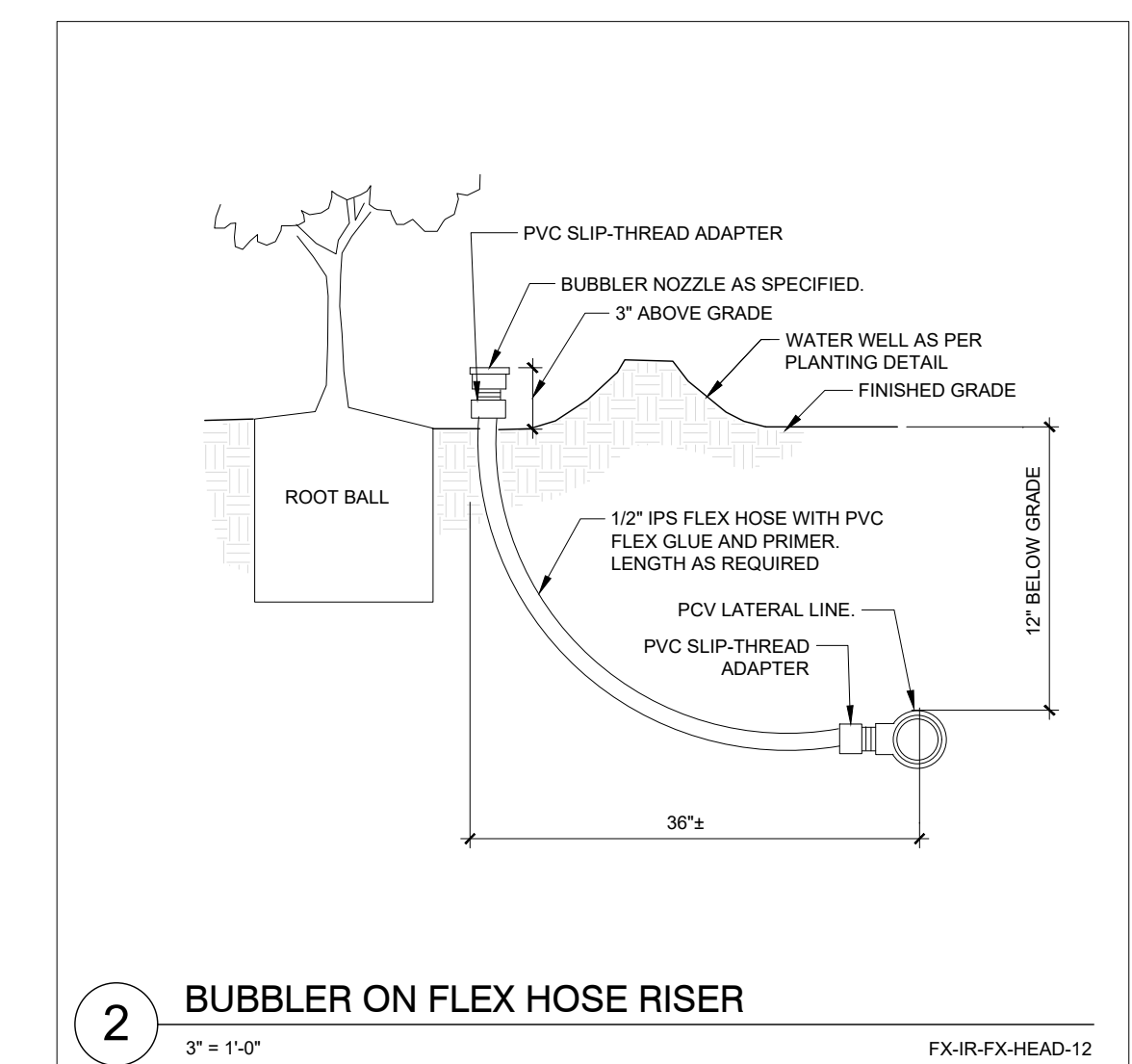
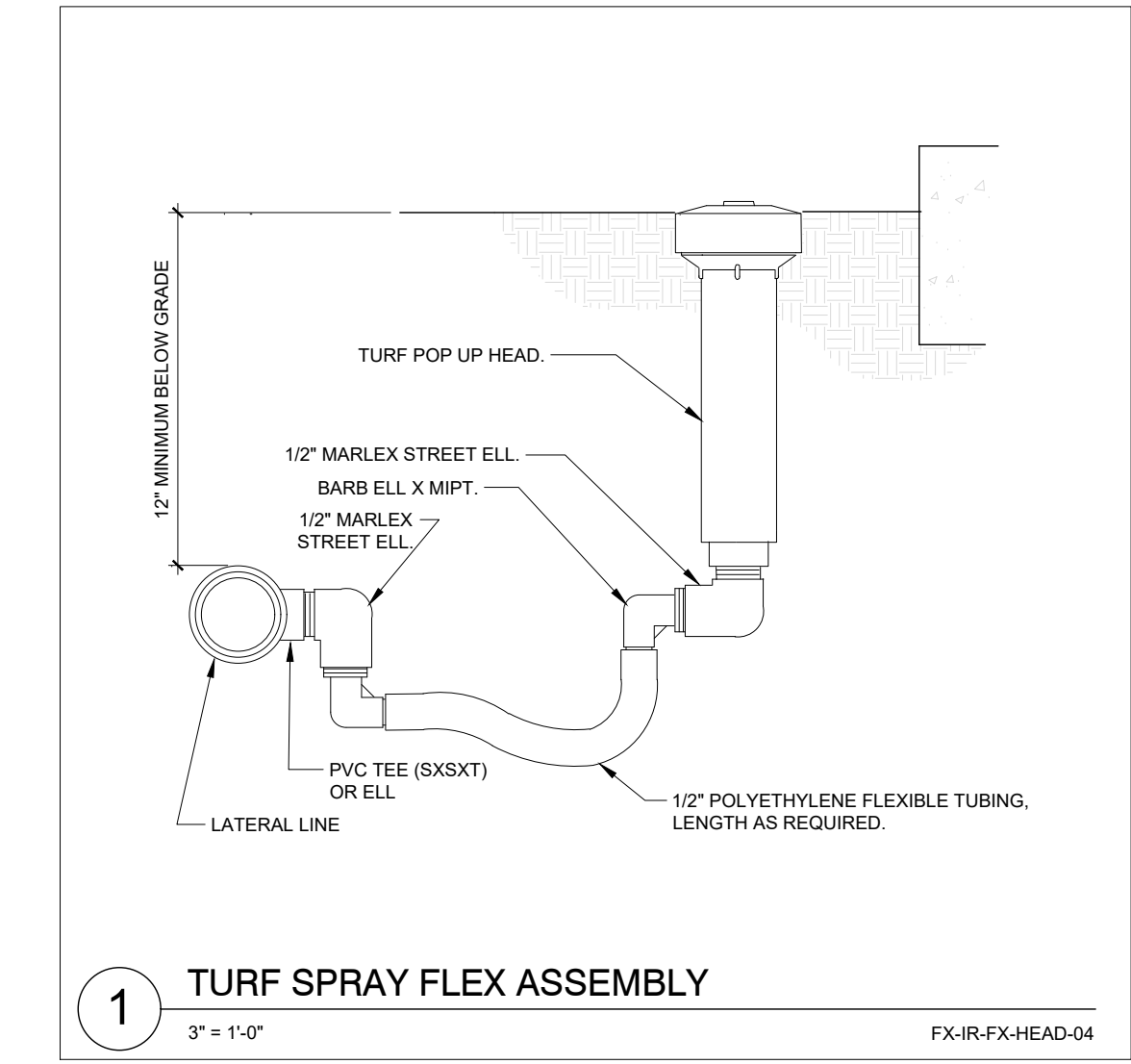

PIPE SIZING CHART

GPM	SIZE	GPM	SIZE
0-10	3/4"	9-13	1"
11-16	1"	14-22	1-1/4"
17-26	1-1/4"	23-30	1-1/2"
27-36	1-1/2"	31-50	2"
37-55	2"	51-70	2-1/2"
56-80	2-1/2"		

CLASS 200
 SCHEDULE 40
 Flows shall maintain velocities of less than 5 feet per second



DMJA
 DAVID M. JONES, JR.
 AND ASSOCIATES, INC.
 LANDSCAPE ARCHITECTS
 AND PLANNERS

2221 McGregor Blvd.
 Fort Myers, Florida 33901
 PHONE: (239) 337-5525
 FAX (239) 337-4494

L.A. LICENSE: LC C00063

PROJECT INFORMATION:
**PINE ISLAND
 FIRE
 DEPARTMENT
 STATION #2**
 St. James,
 Lee County,
 Florida

PREPARED FOR:
 TDM Consulting, Inc
 1520 Royal Palm
 Square Blvd.
 Suite 100
 Fort Myers, FL 33919
 Phone:
 239-433-4231
 Fax: 239-433-9632
 Email:
 dean@tdmconsulting.com

CONSULTANT:

DESIGN PROFESSIONAL:
 JAROD A. PRENTICE, R.L.A.
 R.L.A. # LA 6667458
 STATE OF FLORIDA

PROJECT NO. 224071
 PROJECT MGR: Greg Diserio
 FILE NAME: ST. JAMES FIRE STATION L.S.
 DESIGNER: GJD
 CAD TECH: GJD
 CHECKED BY: GJD
 ISSUED FOR:

PERMITTING

ISSUED DATE: JAN. 17, 2025
 REVISIONS:
 MARCH 14, 2025 RAI RESPONSE

SHEET TITLE:
**LANDSCAPE
 & IRRIGATION
 DETAILS & NOTES**

SHEET NUMBER:
L - 4